

SECTION 5

EMISSION CONTROL SYSTEM

NOTICE:

Refer to the Section "5. EMISSION CONTROL SYSTEM" of 99500-84000-01E SERVICE MANUAL (ALTO) for necessary information concerning the subject of this section.

5

SECTION 6

6

ENGINE COOLING SYSTEM

NOTICE:

For the items not found in this section, refer to the section "6. ENGINE COOLING SYSTEM" of 99500-84000-01E SERVICE MANUAL (ALTO).

REMOVAL

Water pump removal

Removal of camshaft timing belt pulley is prerequisite to water pump removal.

When removing timing belt pulley, be sure to use special tools "A" and "B" as shown below so that camshaft is prevented from turning.

"A" : Pulley holder (09930-40113)

"B" : Attachment (09930-40120)

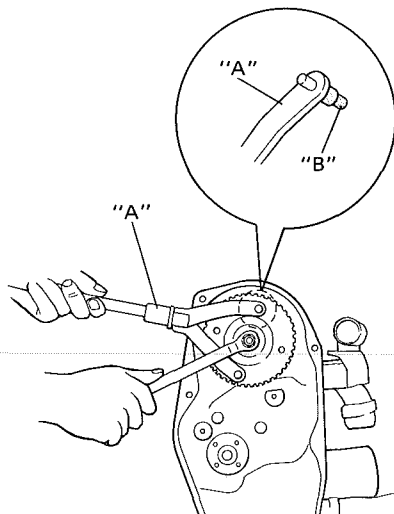

Fig. 6-1

MAINTENANCE SERVICE

Coolant

ANTI-FREEZE PROPORTIONING CHART

Freezing Temperature	°C	-16	-36
	°F	3	-33
GOLDEN CRUISER Concentration	%	30	50
Ratio of compound to cooling water	liters	0.90/2.10 (1.05/2.45)	1.50/1.50 (1.75/1.75)

() For Automatic Transmission car

COOLANT CAPACITY

Item	Model	Manual transmission	Automatic transmission
Engine, radiator and heater		2.4 liters	2.9 liters
Reservoir tank		0.6 liters	0.6 liters
Total		3.0 liters	3.5 liters

